

MICROFILMED

MAG NORTH

IPP S 27-54 W 140.01 IPP  
(209) OIP (787) OIP (409)

208.60  
S 62-55 E

206.62  
M 55-29 N

FILED  
GREENVILLE CO. S. C.  
JUN 7 2 04 PM '78  
DONNIE S. TANKERSLEY  
R.M.C.

ROBINHOOD RD

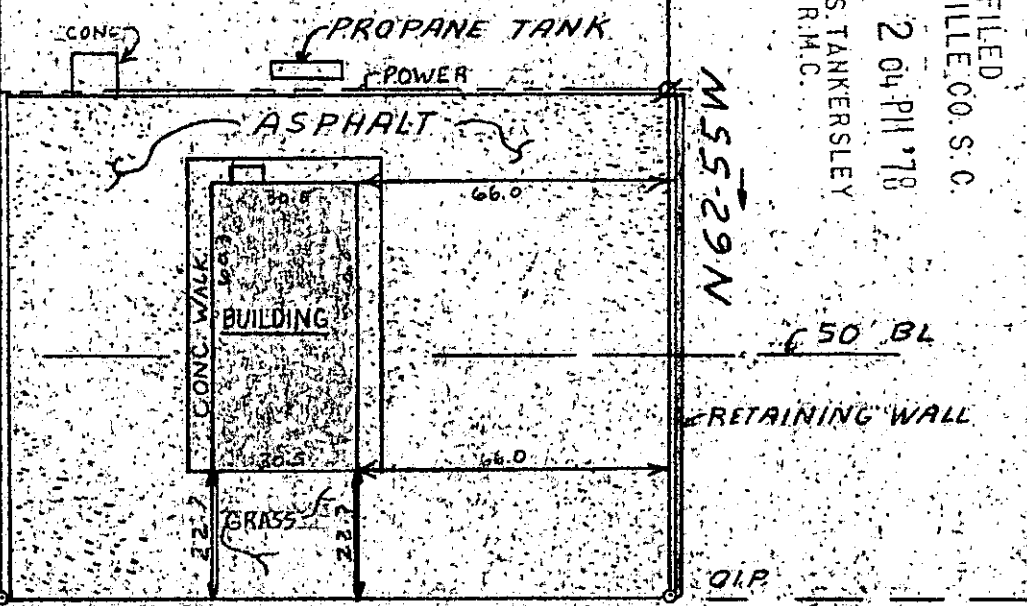

N 27-05 E 140.00 (100')

**S. C. BY PASS - 291 (SOUTH PLEASANTBURG DR)**

This is to certify that on May 29, 1978, I surveyed the property shown on this plat known as Pizza Hut on 291 By-Pass, recorded in the R.M.C. Office of Greenville County in Deed Book 1031 on Page 245, and that the property lines, walls, and buildings are as shown hereon, that the building located on said lot does not encroach or project on adjacent streets or property, and that no adjacent walls or buildings encroach or project on said premises and that no utility lines cross this property except as shown hereon. This property is not located in a flood hazard area.

36788 *James R. Freeland*  
James R. Freeland RLS 2PE 4781

266-1-11.11 ✓ 6-Q-73



SEAL

**STATE OF SOUTH CAROLINA  
GREENVILLE COUNTY**

**PENGUIN PROPERTY  
A GENERAL PARTNERSHIP  
PIZZA HUT  
ON BY-PASS S.C. 291**

**FREELAND & ASSOCIATES**  
Engineers • Land Surveyors

GREENVILLE, S. C.

SURVEY	DG
DRAWN	JRF
CHECK	M.C.
SCALE	1" = 40'
DATE	5-20-78
DWG. NO.	204-2180